



Description

The EST-EXD series have excellent explosion-proof performance. It is suitable for hazardous locations which include the explosive gas environment.

The EST-EXD102 conventional rate of rise heat detector uses thermal components to detect the temperature in the environment. It can enable fire alarm when the temperature difference achieved the setting rate of rise temperature value.

This detector can be used with the conventional fire alarm panel.

Features

- LED indicator
- Excellent explosion-proof performance
- Meets all requirements of latest
- EN54-7:2000 and EN54-5:2000
- Easy Installation

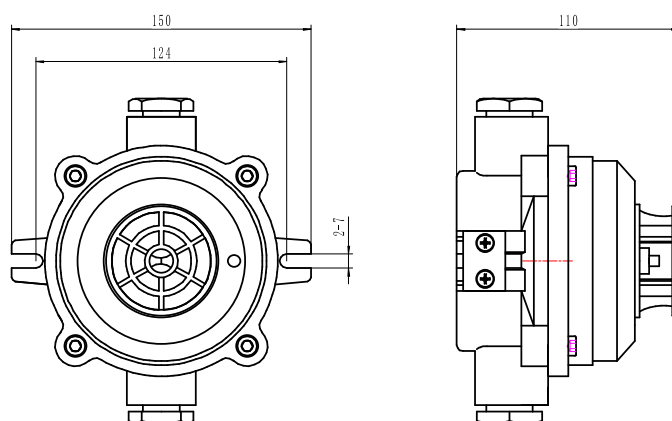

Technical Specification

Model	EST-EXD102
Main Voltage	DC24V±3V (no polarity)
Operating current	Monitor: 60 A Alarm: ≤30mA
Alarm Relay Output	Normally Open and Closed
Fix Temperature Alarm	57 (135°F)
Rate of Rise Alarm	7.1 /5S
Ex-Atex Protection Level	Exd II C T6 Gb
Materials and colors	CAST IRON ABS, White
Mating Host	EST-CFP2166 fire alarm control panel
Outlet Interface	G20
Environmental	Temperature range: -10 to 55°C (14~131°F)
Humidity:	5 to 95% RH, non-condensing
Size	150mm* 150mm* 110mm
Weight	About 1.2kg