

MULTI GAS DETECTOR

EST-BX616 Portable Multi-gas Detector

FEATURES

- Small size and light-weight
- Simple operation with only 1 button
- Adjustable alarm levels and span calibration value
- STEL and TWA alarm for toxic gases function
- Self-protection for combustible gas sensor against high concentration
- Battery low voltage alert
- Confidence beep
- Self-test after power on
- Self-diagnostic and self-correction



APPLICATION

Steelworks, petrochemical plant, oil industry, shipbuilding yard, sewage treatment plant, mine, power supply works, confined spaces etc.

EST-BX616 is a multi-gas detector which can be combustible gases, O₂, CO and HS₂ gases in the air. Its functional and watertight design (IP66) incorporates a Bump proof, rubberized housing to meet the toughest requirement of harsh environment like underground tunnels, mines etc.

APPEARANCE

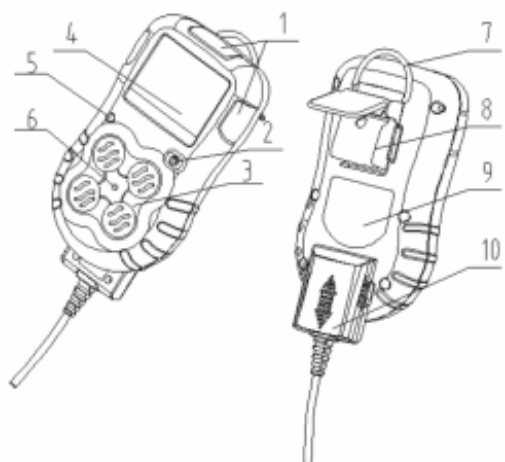

- | | |
|--------------------|----------------------------------|
| 1. Alarm indicator | 6. Calibration cap fasten hole |
| 2. Button | 7. Hand strap |
| 3. Sensor channel | 8. alligator clip |
| 4. Display screen | 9. Label |
| 5. Buzzer | 10. charging/ communication port |

SPECIFICATIONS Note: For detecting other gases, please refer to our gas list.

Measuring gas	O2	CO	H2S	Combustible	Working temperature	Toxic gases: -20℃ ~ 50℃ Combustible: -40℃ ~ 70℃
Measuring range	0-25%VOL	0-500ppm	0-100ppm	0-100%LEL		
Sensor type	Electrochemical			Catalytic	WorkinAg humidity	<95%RH (no condensation)
Measuring type	Diffuse naturally				Housing	Rubber enclosure
Response time	T ₉₀ <30s				Standard accessories	Operation manual, calibration cap, charger, screwdriver, USB cable
Display	LCD screen					
Audible	≥80dB at 1m				Dimension & weight	120mm*68mm*30mm, about 220g
Alarm method	Visual, audible and vibrative signals				Ingress protection	IP66
Battery	DC3.7V 1800mAh Lithium battery				Ex grade	 II 2G Ex ia IIC T4 Ga or II 2G Ex db ia IIC T4 Gb
Operating life	≥8h per charge (Charging time: 4-6h)					
Event log	2000 events					